

REVISIONS		
REV. NO.	DESCRIPTION	DATE

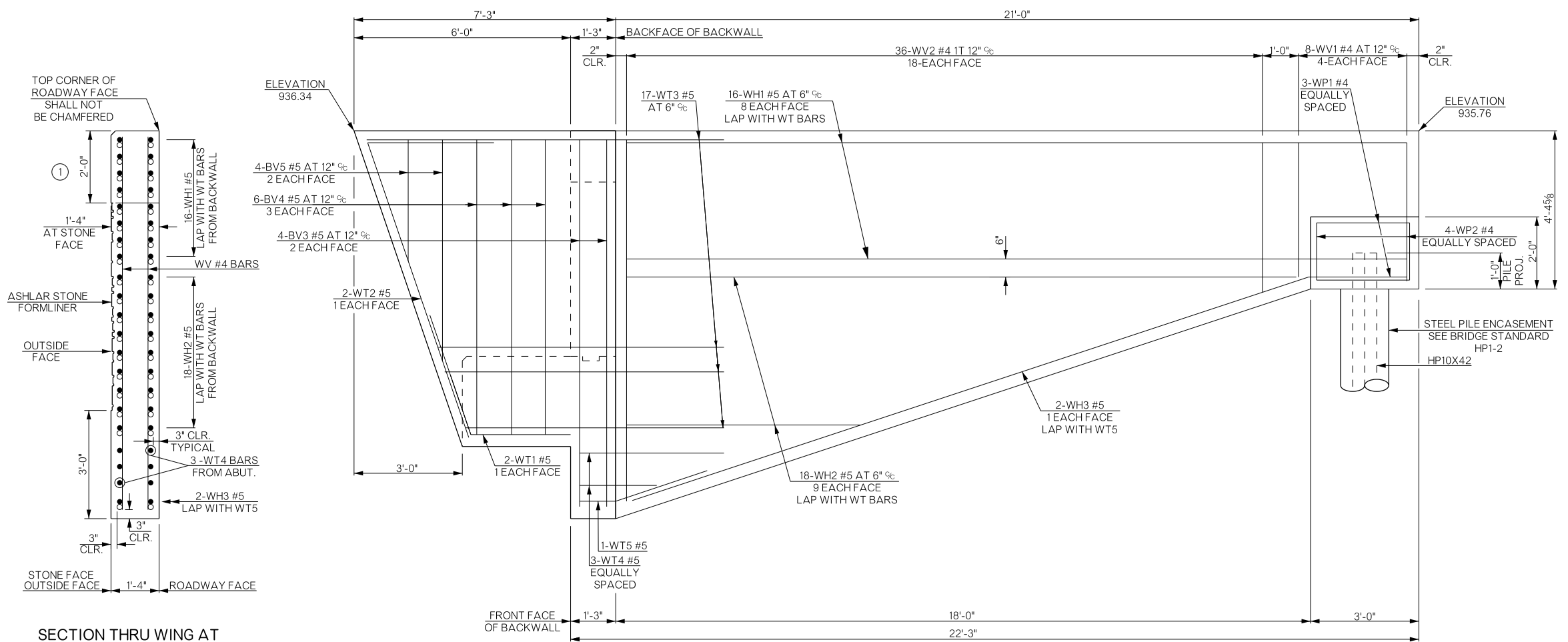

SECTION THRU WING AT BACKFACE OF ABUTMENT SEAT

① MATCH MSE WALL COPING HEIGHT.

LONGITUDINAL SECTION AT PHASE II OF ABUTMENT NO. 1

PHASE II BAR LIST - ABUTMENT NO. 1					
MARK	NO.	SIZE	FORM	LENGTH	VARIANCE
EPOXY COATED					
BH1	10	#4	STR.	34'-9"	
BH2	8	#4	BNT.	35'-8"	
BH3	10	#9	STR.	34'-9"	
BH4	15	#4	BNT.	5'-1"	
BV1	33	#4	STR.	9'-4" AVG.	9'-0" TO 9'-8"
BV2	33	#5	STR.	9'-4" AVG.	9'-0" TO 9'-8"
BV3	4	#5	STR.	10'-1"	
BV4	6	#5	STR.	8'-1"	
BV5	4	#5	STR.	4'-3" AVG.	2'-10" TO 5'-8"
WT1	2	#5	BNT.	6'-3"	
WT2	2	#5	BNT.	11'-3"	
WT3	17	#5	BNT.	18'-4" AVG.	15'-6" TO 21'-2"
WT4	3	#5	BNT.	8'-9" AVG.	5'-7" TO 11'-8"
WT5	1	#5	BNT.	8'-6"	
P1	24	#4	BNT.	6'-0"	
P2	16	#4	BNT.	7'-8"	
P3	2	#4	BNT.	14'-11"	
S1	47	#5	BNT.	12'-11"	

PHASE II BAR LIST - ONE WING					
MARK	NO.	SIZE	FORM	LENGTH	VARIANCE
EPOXY COATED					
WH1	16	#5	STR.	20'-8"	
WH2	18	#5	STR.	11'-6 1/2" AVG.	5'-8" TO 17'-5"
WH3	2	#5	BNT.	21'-7"	
WV1	8	#4	STR.	3'-11"	
WV2	36	#4	STR.	7'-1" AVG.	4'-3" TO 9'-11"
WP1	3	#4	BNT.	8'-8"	
WP2	4	#4	STR.	1'-7"	

① TWO SETS OF 9 BARS

QUANTITIES - PHASE II - ABUTMENT NO. 1			
ITEM	UNIT	TOTAL	
SUBSTRUCTURE EXCAVATION COMMON	C.Y.	60.0	
CLSM BACKFILL	C.Y.	62.0	
CLASS A CONCRETE	C.Y.	37.0	
EPOXY COATED REINFORCING STEEL	LB.	4470.0	
PILES, FURNISHED (HP 10 X 42)	L.F.	56.0	
PILES, DRIVEN (HP 10 X 42)	L.F.	56.0	
PILES, FURNISHED (HP 12 X 53)	L.F.	268.0	
PILES, DRIVEN (HP 12 X 53)	L.F.	268.0	
6" PERFORATED PIPE UNDERDRAIN ROUND	L.F.	32.0	
6" NON-PERFORATED PIPE UNDERDRAIN ROUND	L.F.	32.0	
WATER REPELLANT (VISUALLY INSPECTED)	S.Y.	52.0	

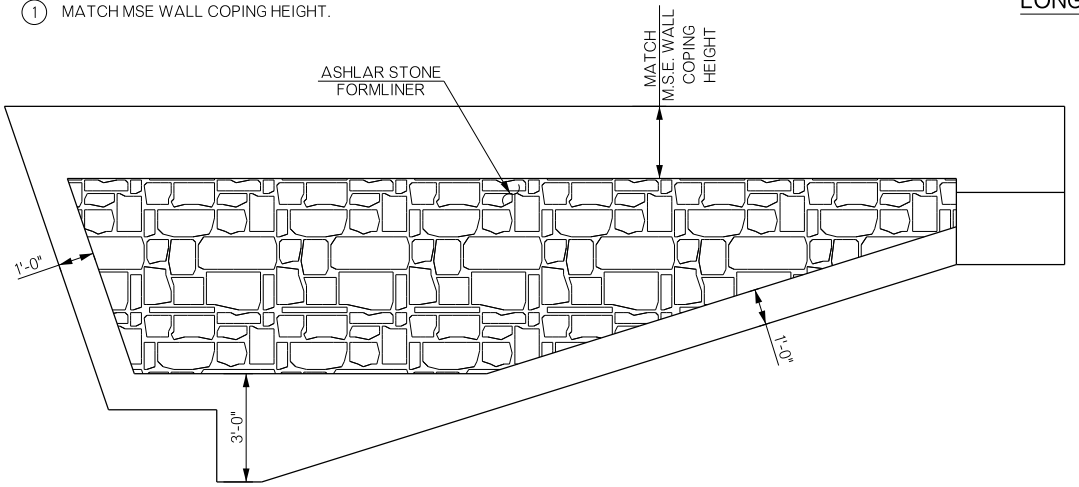

DETAILS OF ASHLAR STONE FORMLINER ON ABUTMENT WING AND BEAM COVER  
FOR DETAILS OF AESTHETIC TREATMENTS, SEE SHEET B046

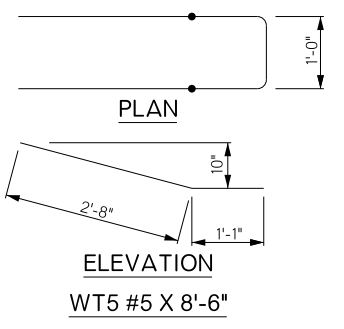
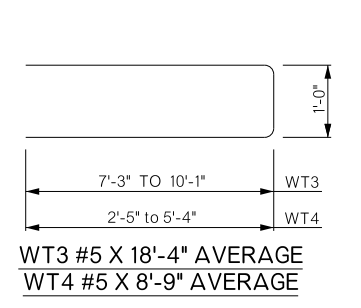
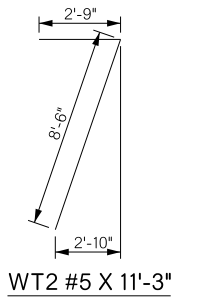
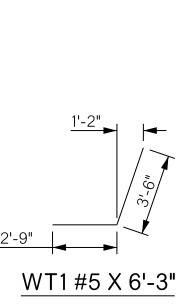
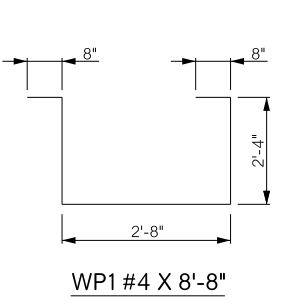
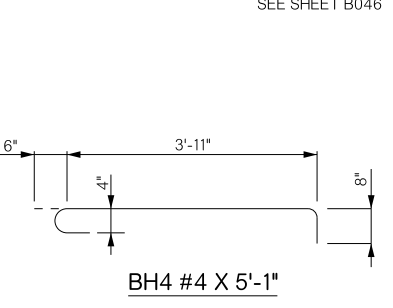
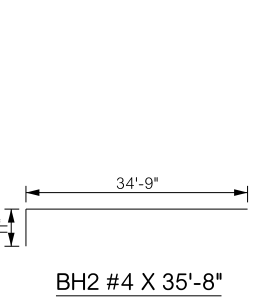
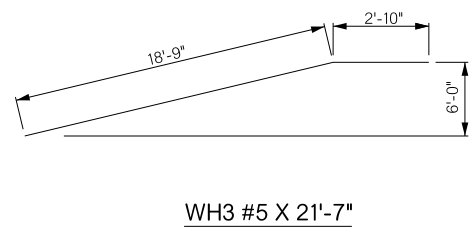
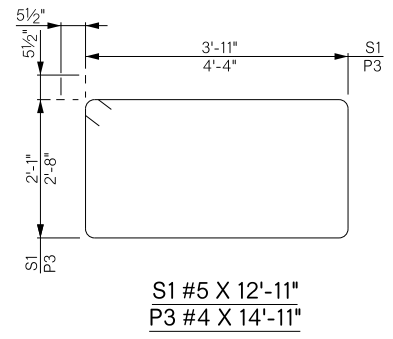
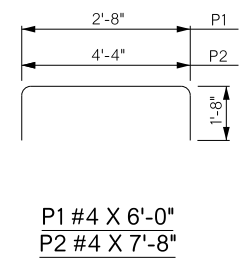

WATER REPELLANT TREATMENT SHALL BE APPLIED TO EXPOSED SURFACES OF THE ABUTMENT INCLUDING: THE TOP OF SEAT, THE BACKWALL, THE PEDESTALS AND PORTIONS OF THE WING WHICH IS EXPOSED.

BRIDGE "A" SH-33 OVER COTTONWOOD CREEK	LOGAN COUNTY	Design	GT	11/15
DETAILS OF ABUTMENT NO. 1 (SHEET 5 OF 5)		Detail	MAP	11/15
		Check	TT	8/16
Squad: PEARSON Engr: HERNANDEZ				